

REF NO: RT - 167 (REV C)

Name: **ROUGH & TUMBLE**

Address: **HOLLAND PATENT,
NY**

Date: 21/12/08

Designer: CPW



The logo features the words "All Kids Play" in a colorful, rounded font. The letters are filled with various colors: 'A' is red, 'l's are green and blue, 'K' is yellow, 'i' is red, 'd's are blue and green, 'P' is red, 'l' is blue, and 'y' is yellow and green. Three simple black stick figures are integrated into the text: one is positioned above the first 'l', another is inside the 'd', and a third is positioned below the 'P'.

Soft Contained Play Units

MAIN AREA

CONTENTS LIST

1. FLOOR PAD
2. TARZAN CLIMB
3. CARGO SLANT CLIMB
4. CRASH PAD
5. DECK
6. CUBE STEP
7. TRI CLIMB OVER
8. WEB DECK
9. WEB ELEVATOR
10. SPIRAL TUBE SLIDE
11. LANING MAT
12. FOAM FOREST
13. STEP UP PAD
14. 90 TUBE SLIDE
15. INFLATABLE BALL
16. CARGO CRAWL THRU
17. SIDE SQUEEZE
18. NETTED ROOF
19. 16 in THIN WEB BRIDGE
20. BOAT BUMPER
21. TRI SQUEEZE MAZE
22. TRIPLE S-TUBE CRAWL

FOOTPRINT (LXW) : 28' x 20'

STRUCTURE HEIGHT : 12'

CONCEPT :

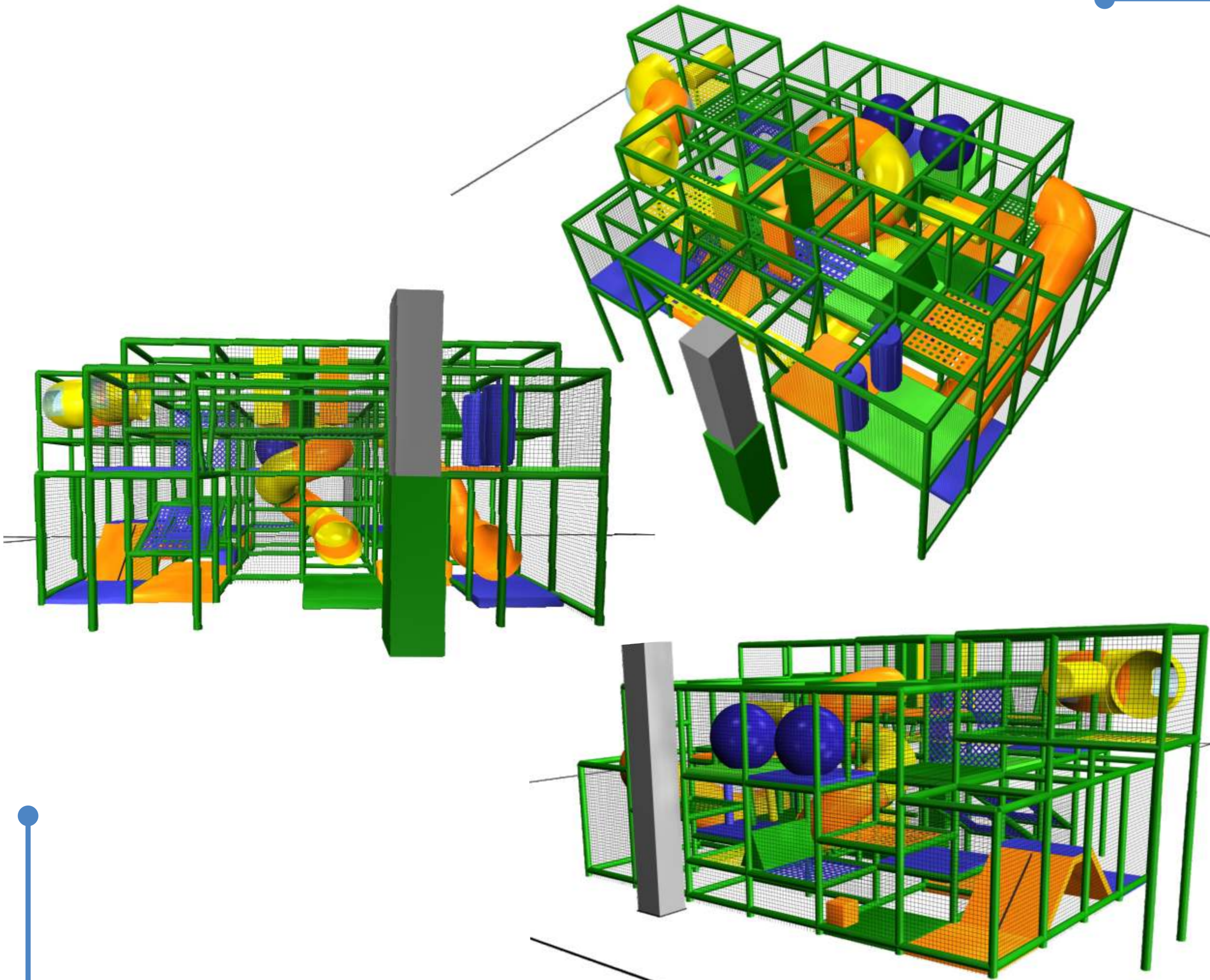

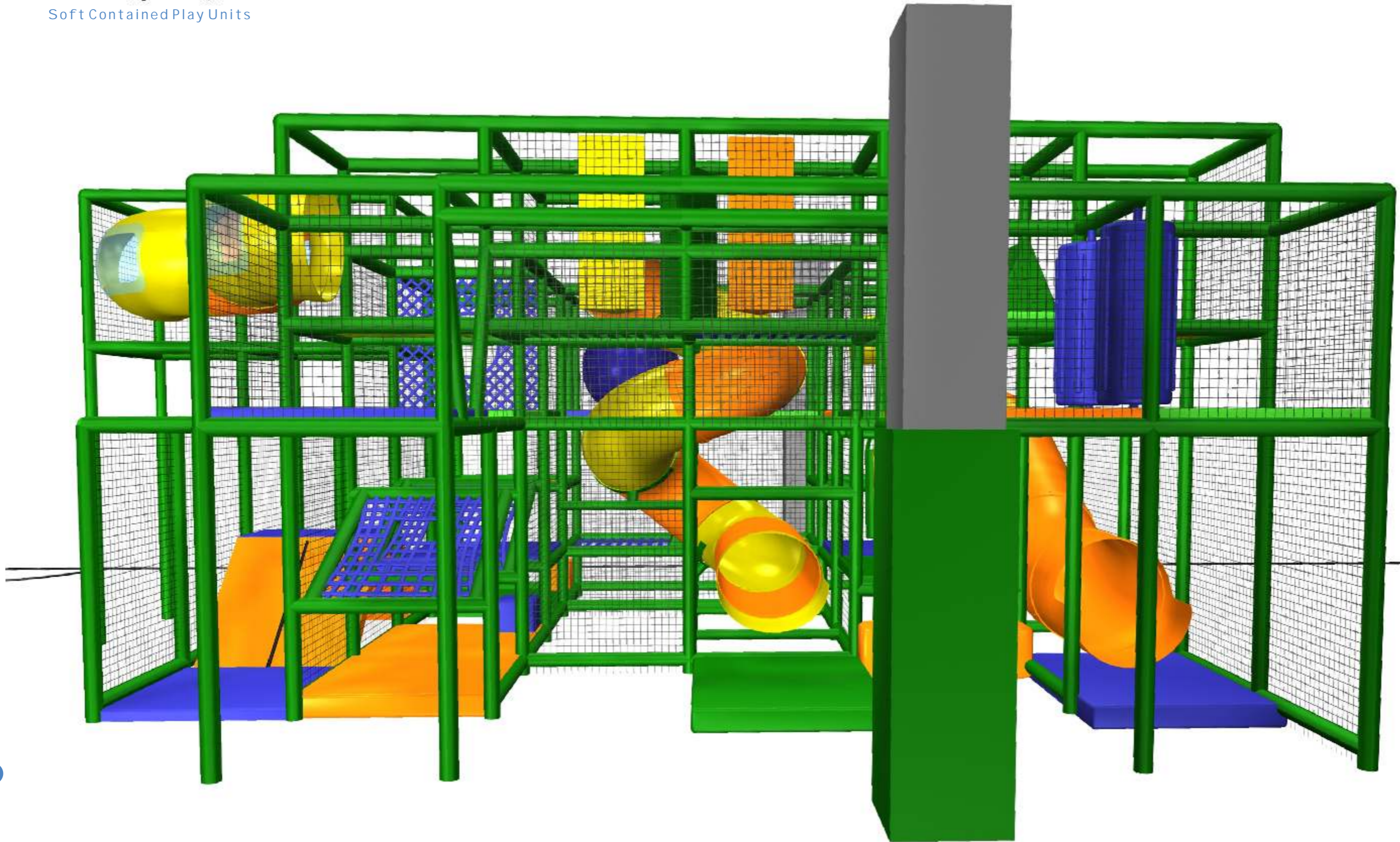

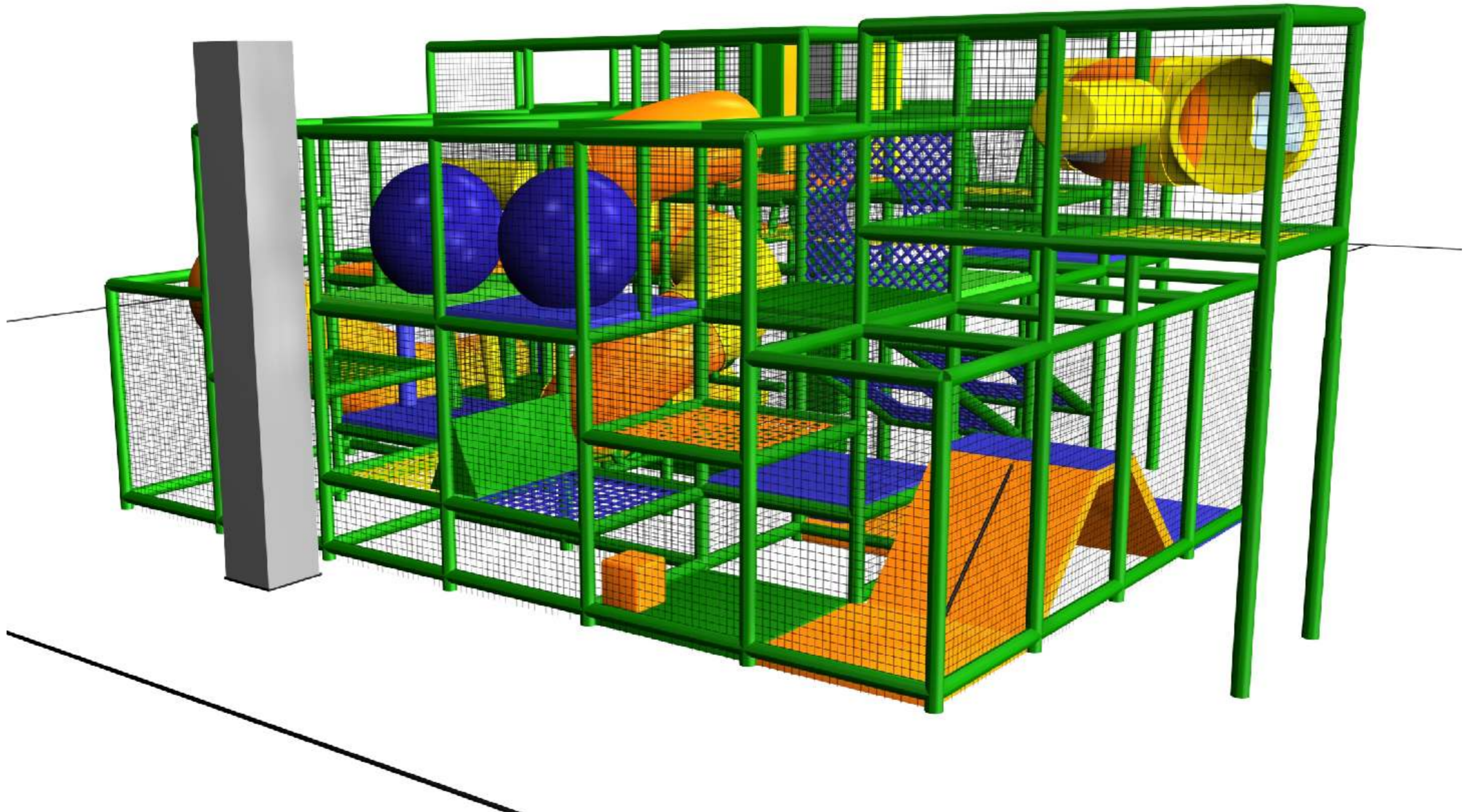

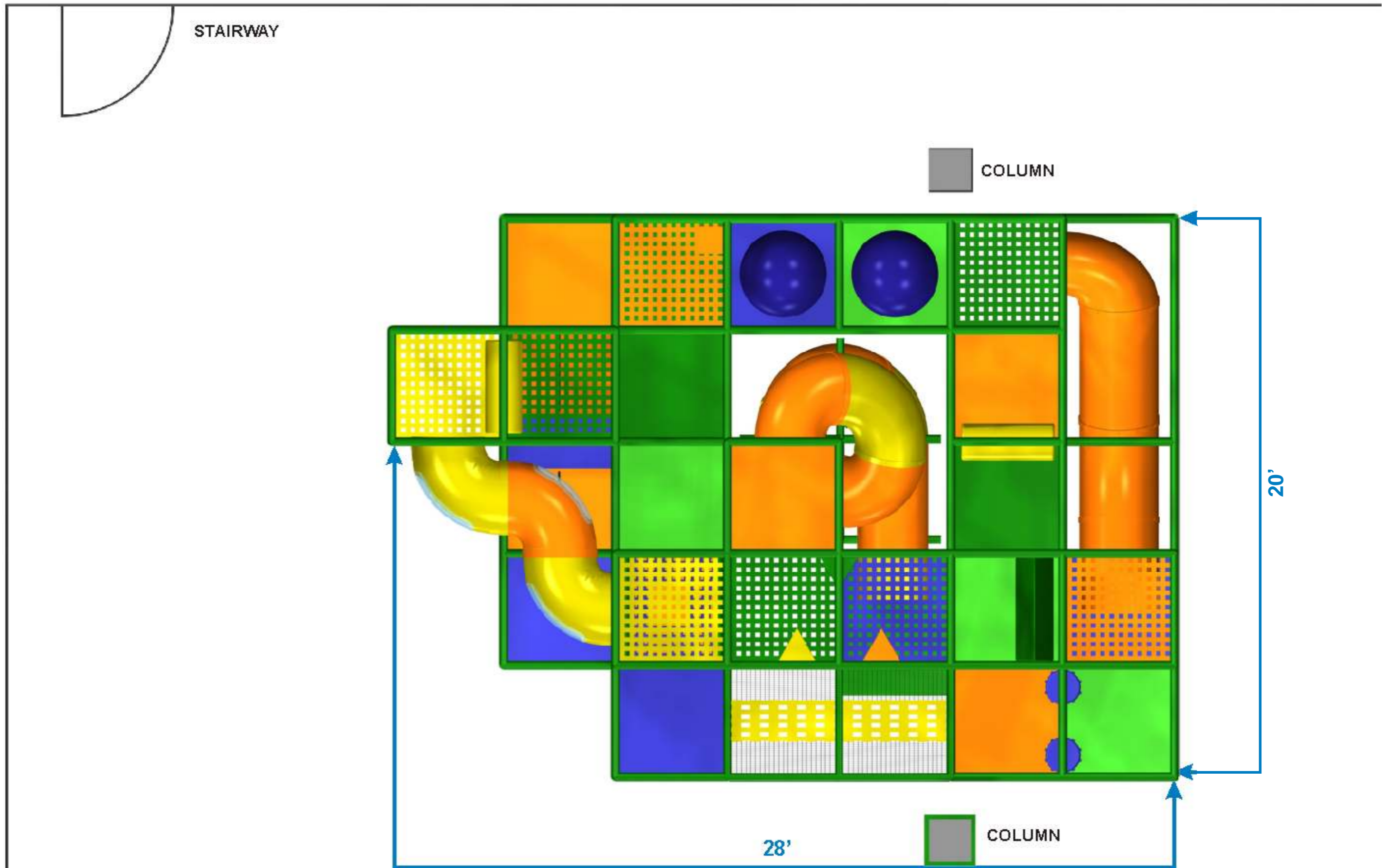

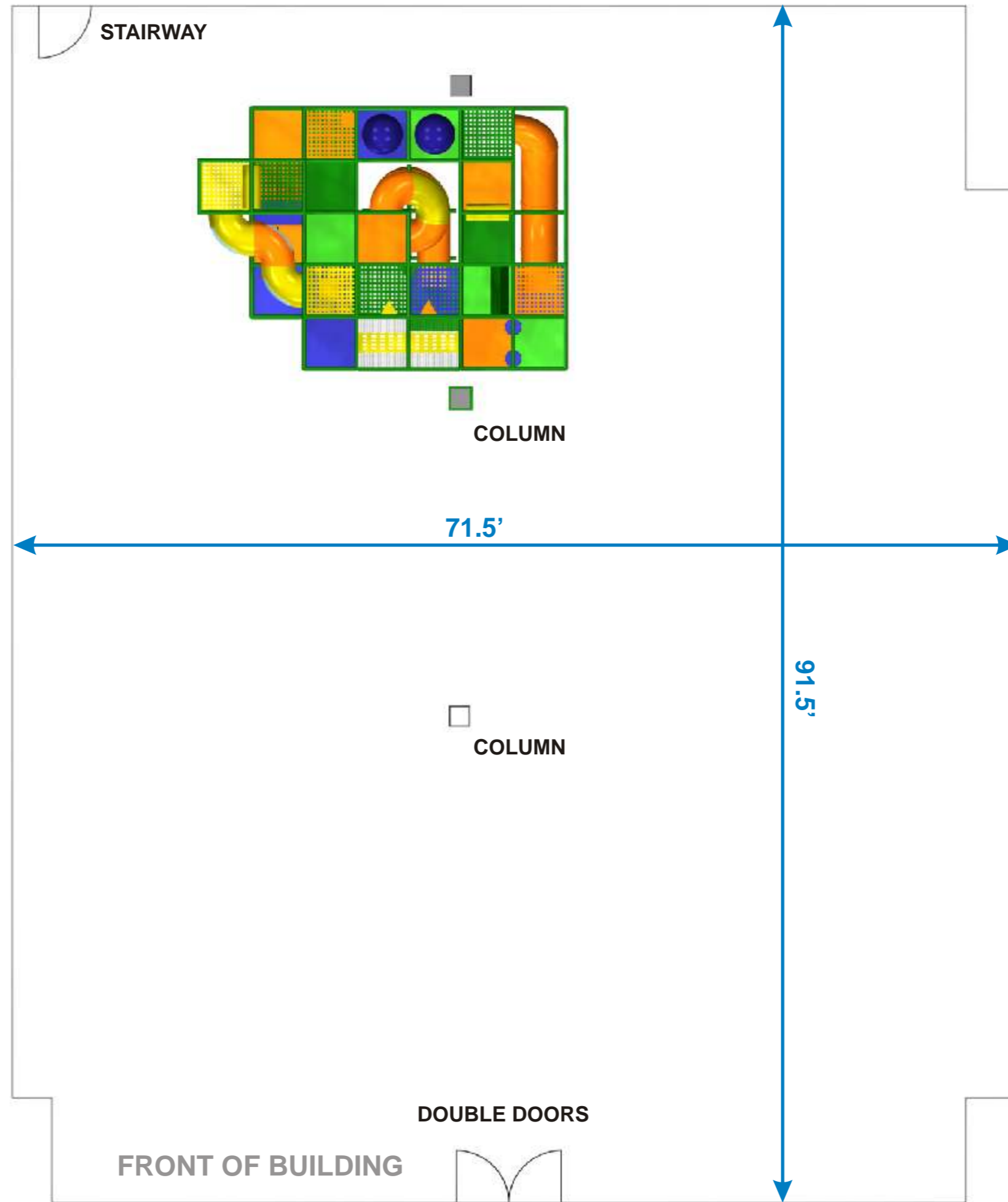

Legend:

1. FLOOR PAD
2. TARZAN CLIMB
3. CARGO SLANT CLIMB
4. CRASH PAD
5. DECK
6. CUBE STEP
7. TRI CLIMB OVER
8. WEB DECK
9. WEB ELEVATOR
10. SPIRAL TUBE SLIDE
11. LANING MAT
12. FOAM FOREST
13. STEP UP PAD
14. 90 TUBE SLIDE
15. INFLATABLE BALL
16. CARGO CRAWL THRU
17. SIDE SQUEEZE
18. NETTED ROOF
19. 16 in THIN WEB BRIDGE
20. BOAT BUMPER
21. TRI SQUEEZE MAZE
22. TRIPLE S-TUBE CRAWL

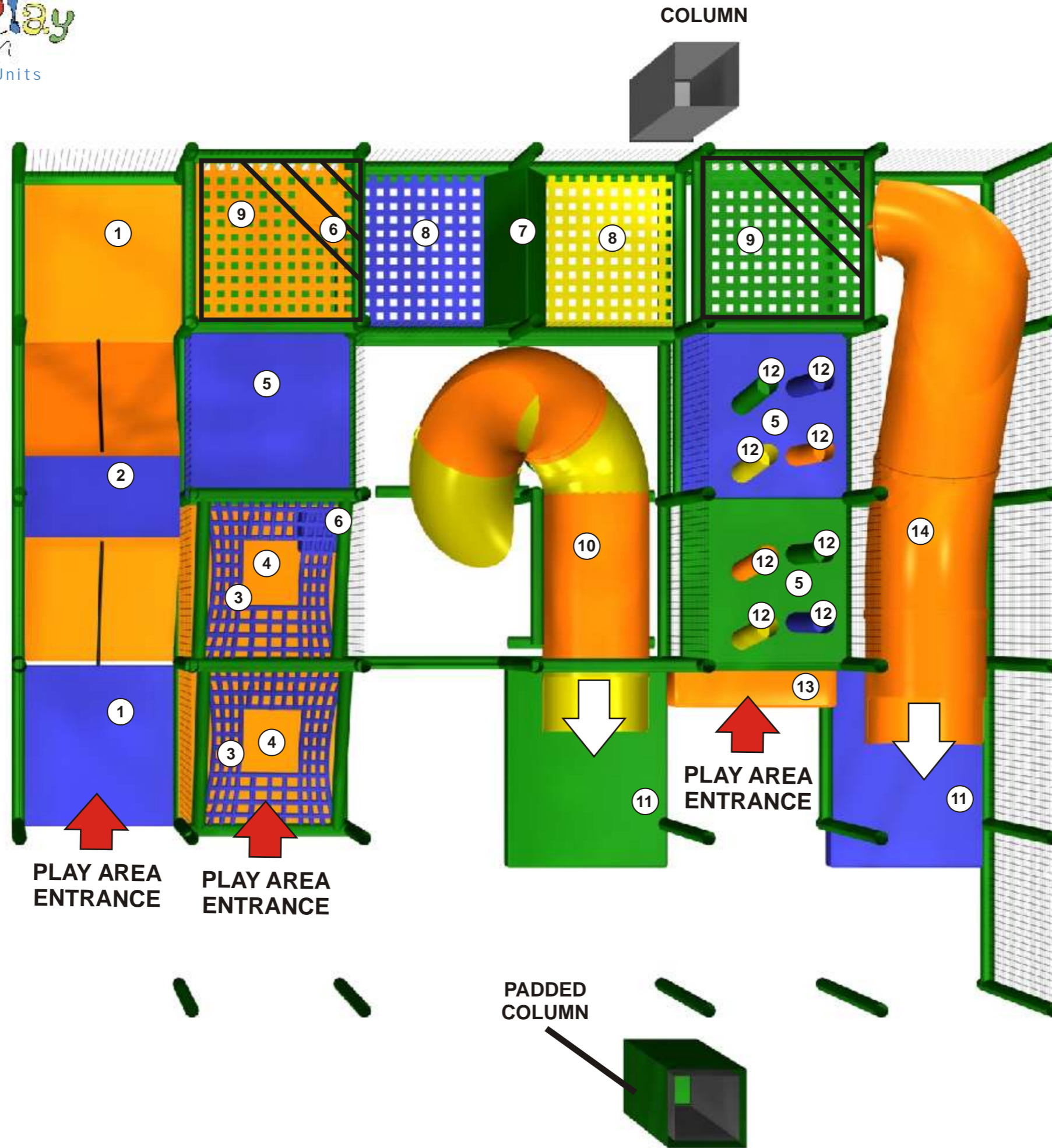

COLUMN

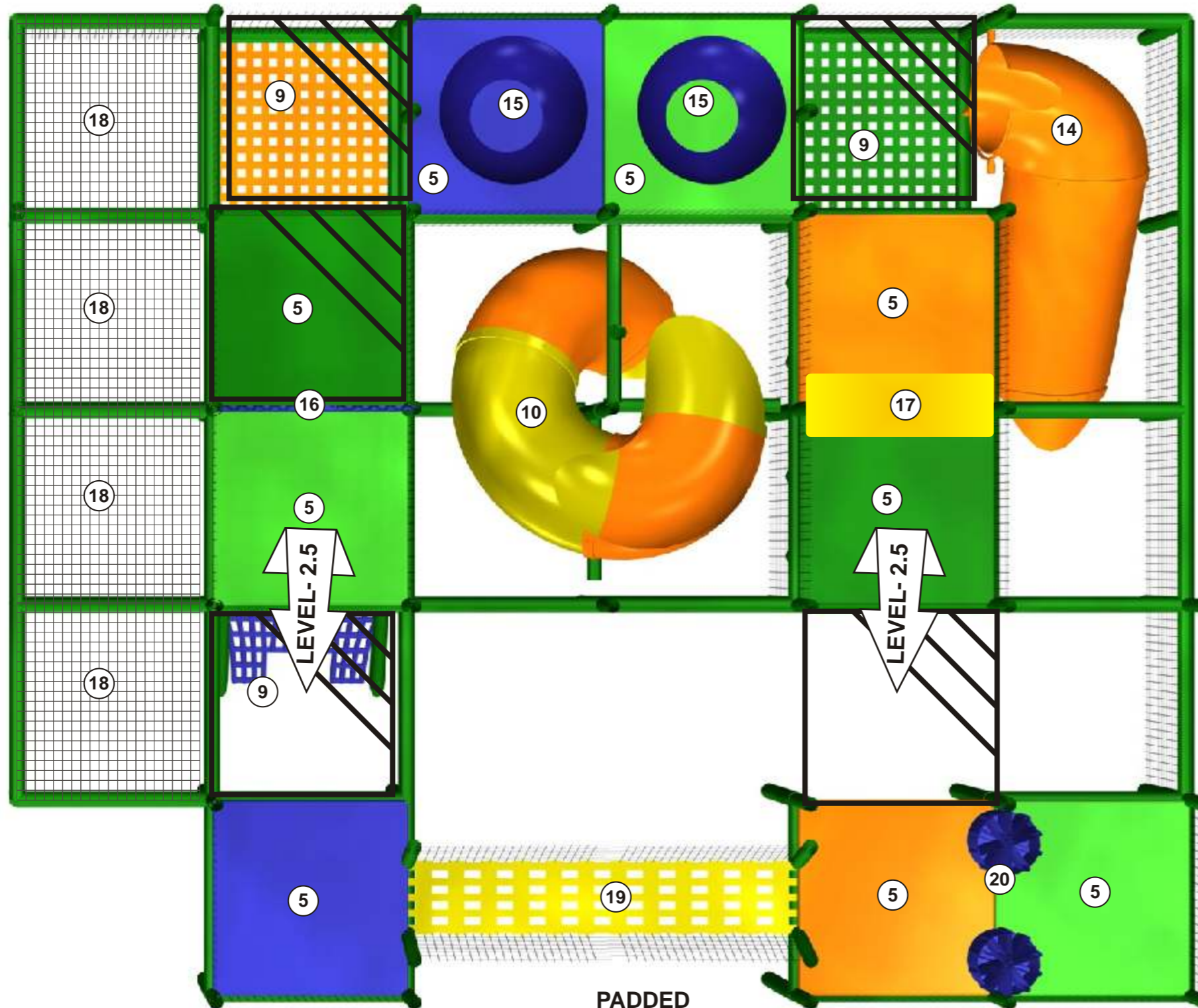

PADDED COLUMN



LEVEL 02: 6' - 8"

Legend:

1. FLOOR PAD
2. TARZAN CLIMB
3. CARGO SLANT CLIMB
4. CRASH PAD
5. DECK
6. CUBE STEP
7. TRI CLIMB OVER
8. WEB DECK
9. WEB ELEVATOR
10. SPIRAL TUBE SLIDE
11. LANING MAT
12. FOAM FOREST
13. STEP UP PAD
14. 90 TUBE SLIDE
15. INFLATABLE BALL
16. CARGO CRAWL THRU
17. SIDE SQUEEZE
18. NETTED ROOF
19. 16 in THIN WEB BRIDGE
20. BOAT BUMPER
21. TRI SQUEEZE MAZE
22. TRIPLE S-TUBE CRAWL

**PADDED
COLUMN**

